

Type VKM

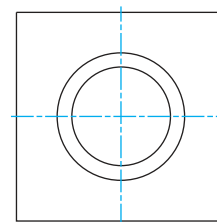
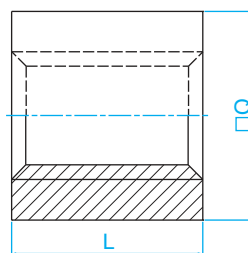
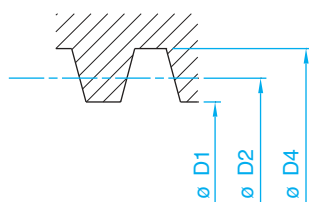
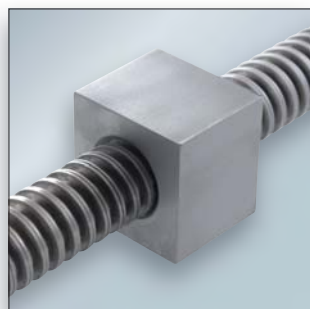

Trapézoïdal suivant ISO 2901/2903 et DIN103

Ecrou - Acier 11SMnPb37 (1.0737) / 11SMn37 (1.0736) - tolérance 7H

Référence Type	Pas - Hand		Dimensions - mm		Taraudage tolérance 7H - mm					Surface de contact	Poids
	Droite Right	Gauche Left	ØA	L	D1		D2		D4	Contact sur- face	Weight
					maxi	mini	maxi	mini	mini	mm / 300 mm	Kg/ M
VKM 10x2	*	*	17	15	8,236	8	9,250	9,0	10,5	169	0,027
VKM 10x3	*	*	17	15	7,315	7	8,800	8,5	10,5	165	0,027
VKM 12x3	*	*	25	18	9,315	9	10,800	10,5	12,5	244	0,076
VKM 14x3	*	*	25	20	11,315	11	12,800	12,5	14,5	322	0,079
VKM 14x4	*	*	25	20	10,375	10	12,355	12,0	14,5	315	0,079
VKM 16x4	*	*	28	24	12,375	12	14,355	14,0	16,5	440	0,119
VKM 18x4	*	*	30	28	14,375	14	16,355	16,0	18,5	587	0,154
VKM 20x4	*	*	35	30	16,375	16	18,355	18,0	20,5	707	0,259
VKM 22x5	*	*	35	33	17,450	17	19,900	19,5	22,5	855	0,240
VKM 24x5	*	*	40	36	19,450	19	21,900	21,9	24,5	1 028	0,354
VKM 26x5	*	*	40	39	21,450	21	23,900	23,5	26,5	1 216	0,363
VKM 28x5	*	*	45	42	23,450	23	25,900	25,5	28,5	1 421	0,506
VKM 30x6	*	*	45	45	24,500	24	27,450	27,0	31,0	1 634	0,513
VKM 32x6	*	*	55	48	26,500	26	29,450	29,0	33,0	1 871	0,891
VKM 36x6	*	*	60	54	30,500	30	33,450	33,0	37,0	2 395	1,163
VKM 40x7	*	*	60	60	33,700	33	36,950	36,5	41,0	2 988	1,216
VKM 44x7	*	*	65	66	37,700	37	40,950	40,5	45,0	3 647	1,538
DOUBLE FILETS											
VKM 10X4	*		17	15	8,236	8	9,280	9,0	10,5	169	0,027
VKM 12X6	*		25	18	9,315	9	10,836	10,5	12,5	244	0,076
VKM 14X6	*		25	20	11,315	11	12,836	12,5	14,5	322	0,079
VKM 16X8	*		28	24	12,375	12	14,398	14,0	14,5	440	0,116
VKM 18X8	*		30	28	14,375	14	16,398	16,0	18,5	587	0,154
VKM 20x8	*		35	30	16,375	16	18,398	18,0	20,5	707	0,259
VKM 22x10	*		35	33	17,450	17	19,948	19,5	22,5	855	0,240
VKM 24x10	*		40	36	19,450	19	21,948	21,5	24,5	1 028	0,354
VKM 28x10	*		45	42	23,450	23	28,948	25,5	28,5	1 421	0,506
VKM 30x12	*		45	45	24,500	24	27,504	27,0	31,0	1 634	0,513
VKM 32x12	*		55	48	26,500	26	29,504	29,0	33,0	1 871	0,891
VKM 36x12	*		60	54	30,500	30	33,504	33,0	37,0	2 395	1,163
VKM 40x14	*		60	60	33,700	33	37,004	36,5	41,0	2 988	1,216

Vis trapézoïdales